

Speedlane 996



The Speedlane 996 optical turnstile offers the ultimate in tailgating detection with its high-density array of sensors, ensuring a negligible false alarm rate even in the busiest of lobbies. The sleek oval cabinet design is available with a variety of finishes, tops and barrier heights including waist high or full height sliding glass.

Models

- SL996HB Horizontal sliding glass
- SL996HBT Tall horizontal sliding glass

All Boon Edam secured entry solutions can easily be integrated with virtually any access control system.





Dimensions and Specifications

Type	A Passage Width	Capacity / Minute*	# of Barriers	Disabled Access	Type of Traffic	B Overall Width	D Barrier Height	E Unit Height	F Passage Length	G Unit Width
996HB	22"	25-30	2	x		62"	38-1/3"	41"	54"	20"
996HB	36"	25-30	2	✓		76"	38-1/3"	41"	54"	20"
996HB-T	22"	25-30	2	x		62"	60" or 72"	41"	54"	20"
996HB-T	36"	25-30	2	✓		76"	60" or 72"	41"	54"	20"

*Depending on access control system, in one direction

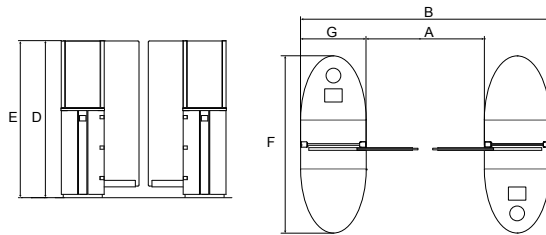

Features and Options

Characteristics	Standard	Option
Two way traffic	•	
LCD user screen	•	
Authorization indicator & audible alarm	•	
Lane open status lights	•	
ADA handicap width	•	
Corian® cabinet top (stock color)	•	
Language customization for LCD screen		•
Security desk control console		•
Metal, Corian®, marble or granite cabinet tops		•

Emergency Egress

The Speedlane 996 will mechanically open by means of spring force in the event of a power failure or fire alarm and will automatically reset once the fire alarm is reset or the power is restored.

User Safety

An advanced sensor system prevents the barriers from closing when a person or object is located in the safety zone. The optional full height barriers are equipped with additional safety sensors.

BoonTouch

Boon Edam offers a universal control panel that can operate up to six different security access solutions from a reception or security desk. Its user friendly, touchscreen interface allows for each solution to be operated separately or simultaneously and displays individual lane alarms with intuitive icons.

Technical Specifications

Power Supply: 110-240 VAC, 50/60 Hz

Power Consumption

Operating: 330W

Ambient Temperature: -4°F to +131°F

Weight: 595 lbs (270 kg)