

DORMA Automatics, Inc.  
924 Sherwood Drive  
Lake Bluff, Illinois 60044

Toll Free: (877)637-6211  
Fax: (877)423-7999

THE STANDARD PACKAGE CONSISTS OF:

(1) RTS OVERHEAD CONCEALED CLOSER, FRAME,  
(1) SWING DOOR, (1) BI-FOLD DOOR, SIDELITES WITH  
VERTICAL AND HORIZONTAL WEATHERSTRIPS.

STANDARD FINISHES: CLEAR BHMA 204  
DARK BRONZE BHMA 313

SPECIAL FINISHES ARE AVAILABLE

DRAWING DIMENSIONS ARE IN ENGLISH AND METRIC UNITS.  
METRICS ARE SHOWN IN MILLIMETERS, AS FOLLOWS: 1" [25.4]

REFER TO APPLICABLE LOCAL, STATE OR NATIONAL BUILDING  
CODES FOR MINIMUM DOOR HEIGHTS AND WIDTHS FOR  
ALLOWABLE EGRESS REQUIREMENTS. SEE REFERENCE TABLE  
BELOW.

SWING DOOR IS USED PRIMARILY WITH BI-FOLD AS BREAKAWAY.

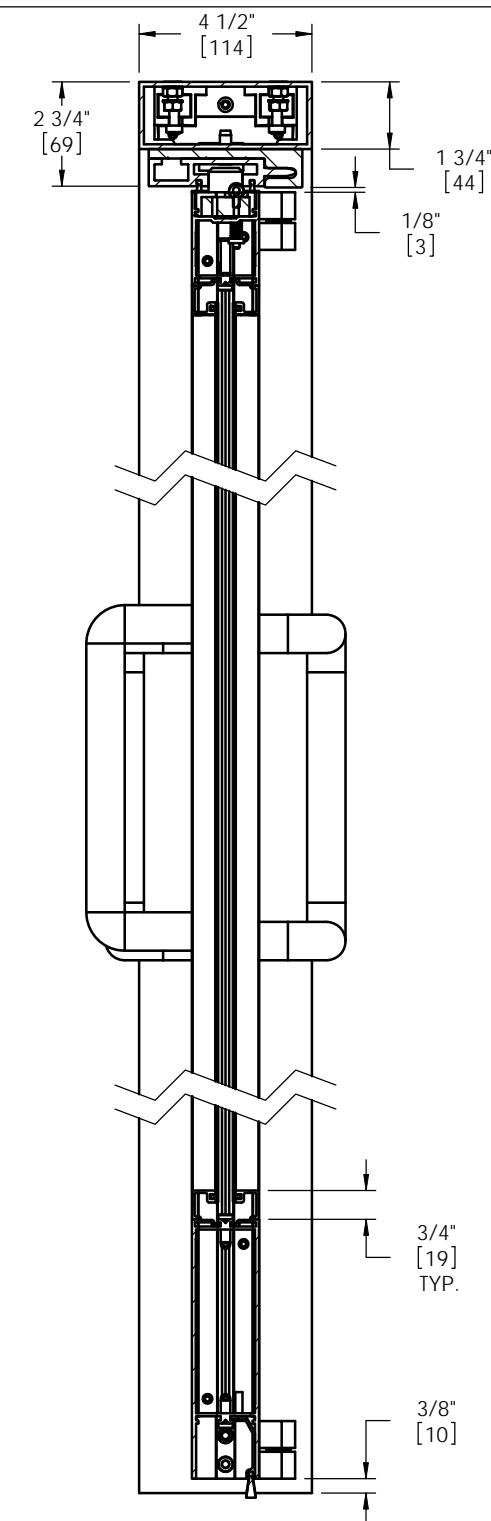
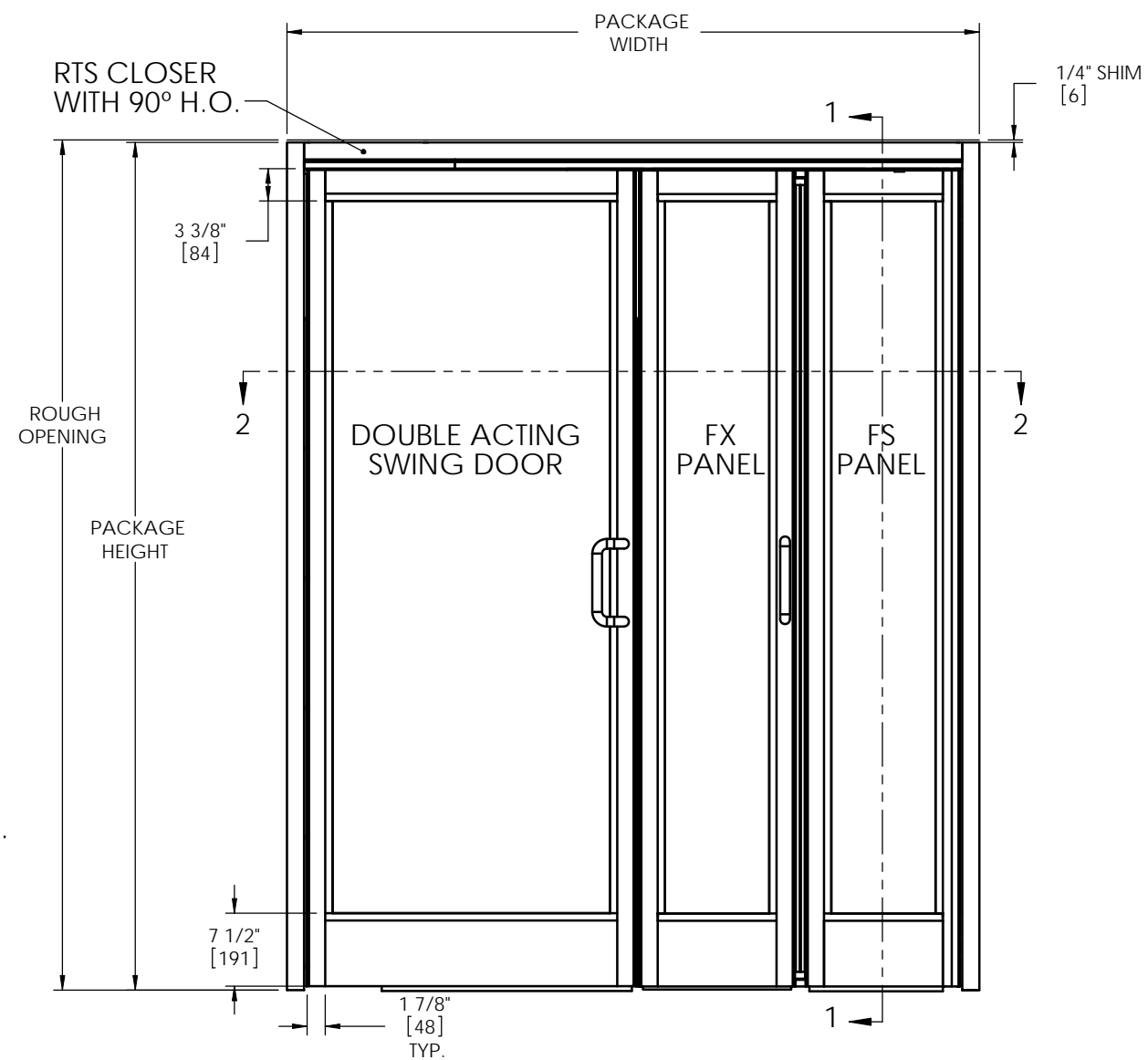

SECTION 1-1  
SCALE 1 : 5

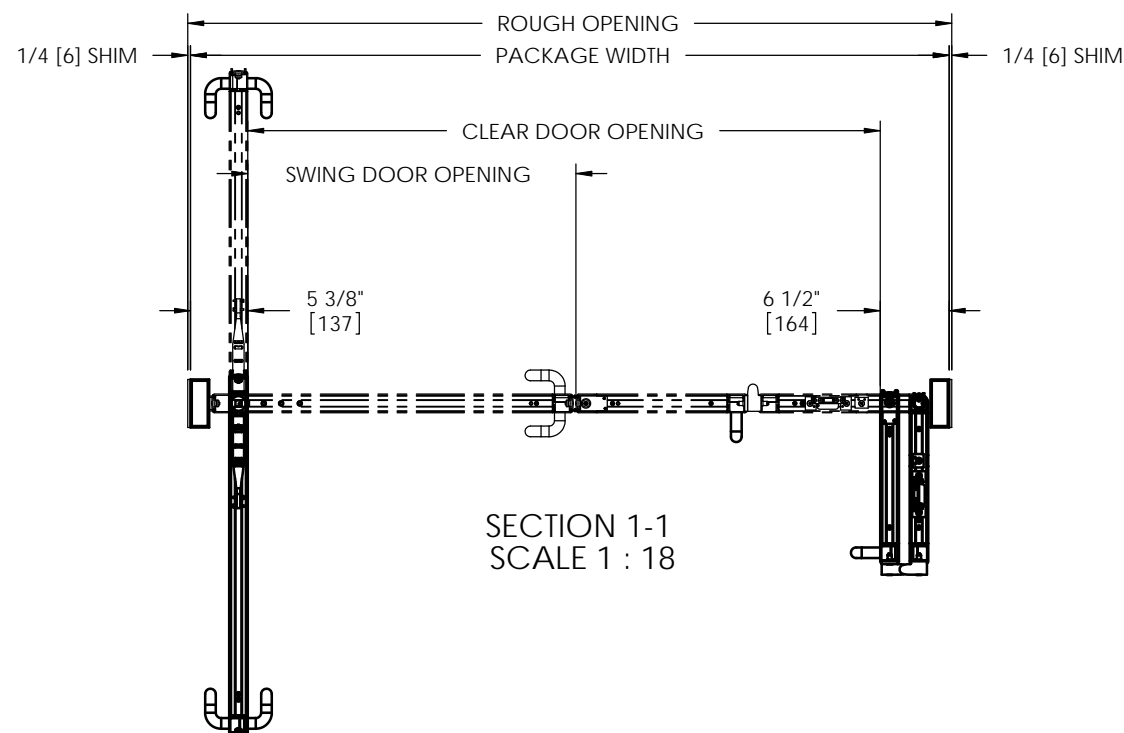

SECTION 1-1  
SCALE 1 : 18

STANDARD PACKAGE HEIGHT IS 88"[2235]  
SWING DOOR IS AVAILABLE AS 36"[914], 42"[1067], OR 48"[1219]  
MAXIMUM RECOMMENDED WIDTH OF BI-FOLD DOOR IS 72"[1829]

Package Width	Swing Door Width	SWING DOOR OPENING	CLEAR DOOR OPENING
84"[2133]	36"[914]	32 3/8"[822]	72 1/8"[1832]
96"[2483]	42"[1067]	38 3/8"[975]	84 1/8"[2137]
120"[3048]	48"[1219]	44 3/8"[1127]	108 1/8"[2746]



**ICU1200 SERIES**  
BI-FOLD/SWING MANUAL DOOR