

# Speedlane 996



**The Speedlane 996 optical turnstile offers the ultimate in tailgating detection with its high-density array of sensors, ensuring a negligible false alarm rate even in the busiest of lobbies. The sleek oval cabinet design is available with a variety of finishes, tops and barrier heights including waist high or full height sliding glass.**

**Models**

- SL996HB Horizontal sliding glass
- SL996HBT Tall horizontal sliding glass

All Boon Edam secured entry solutions can easily be integrated with virtually any access control system.





## Dimensions and Specifications

Type	A Passage Width	Capacity / Minute*	# of Barriers	Disabled Access	Type of Traffic	B Overall Width	D Barrier Height	E Unit Height	F Passage Length	G Unit Width
996HB	22"	25-30	2	x		62"	38-1/3"	41"	54"	20"
996HB	36"	25-30	2	✓		76"	38-1/3"	41"	54"	20"
996HB-T	22"	25-30	2	x		62"	60" or 72"	41"	54"	20"
996HB-T	36"	25-30	2	✓		76"	60" or 72"	41"	54"	20"

\*Depending on access control system, in one direction

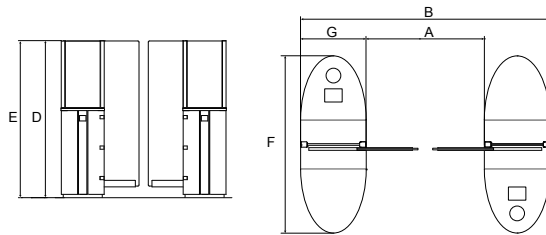

## Features and Options

Characteristics	Standard	Option
Two way traffic	•	
LCD user screen	•	
Authorization indicator & audible alarm	•	
Lane open status lights	•	
ADA handicap width	•	
Corian® cabinet top (stock color)	•	
Language customization for LCD screen		•
Security desk control console		•
Metal, Corian®, marble or granite cabinet tops		•

## Emergency Egress

The Speedlane 996 will mechanically open by means of spring force in the event of a power failure or fire alarm and will automatically reset once the fire alarm is reset or the power is restored.

## User Safety

An advanced sensor system prevents the barriers from closing when a person or object is located in the safety zone. The optional full height barriers are equipped with additional safety sensors.

## BoonTouch

Boon Edam offers a universal control panel that can operate up to six different security access solutions from a reception or security desk. Its user friendly, touchscreen interface allows for each solution to be operated separately or simultaneously and displays individual lane alarms with intuitive icons.

## Technical Specifications

Power Supply: 110-240 VAC, 50/60 Hz

### Power Consumption

Operating: 330W

Ambient Temperature: -4°F to +131°F

Weight: 595 lbs (270 kg)